

MURRAY COUNTY.



June 25 1907

J. H. Thosletonecraft

"F" Fence Cor NW 40° : Tel pole S.W. 50° : Fence post S.E. 44° : Fence Cor. NE 39°

"G" Fence post North 33° : Fence post South 33°

"H" Fence N.W. 38.5° : Fence post NE. 47.5° : Fence post S.W. 46°

E 5/8" Iron stake 40' West of 2' North of 6" Iron post E. fence line
 (136' N.E. Koopman)

26
 27
 28
 29
 30
 31
 32
 33
 34
 35
 36

SURVEY No. _____

Section 27 Town 105 Range 39

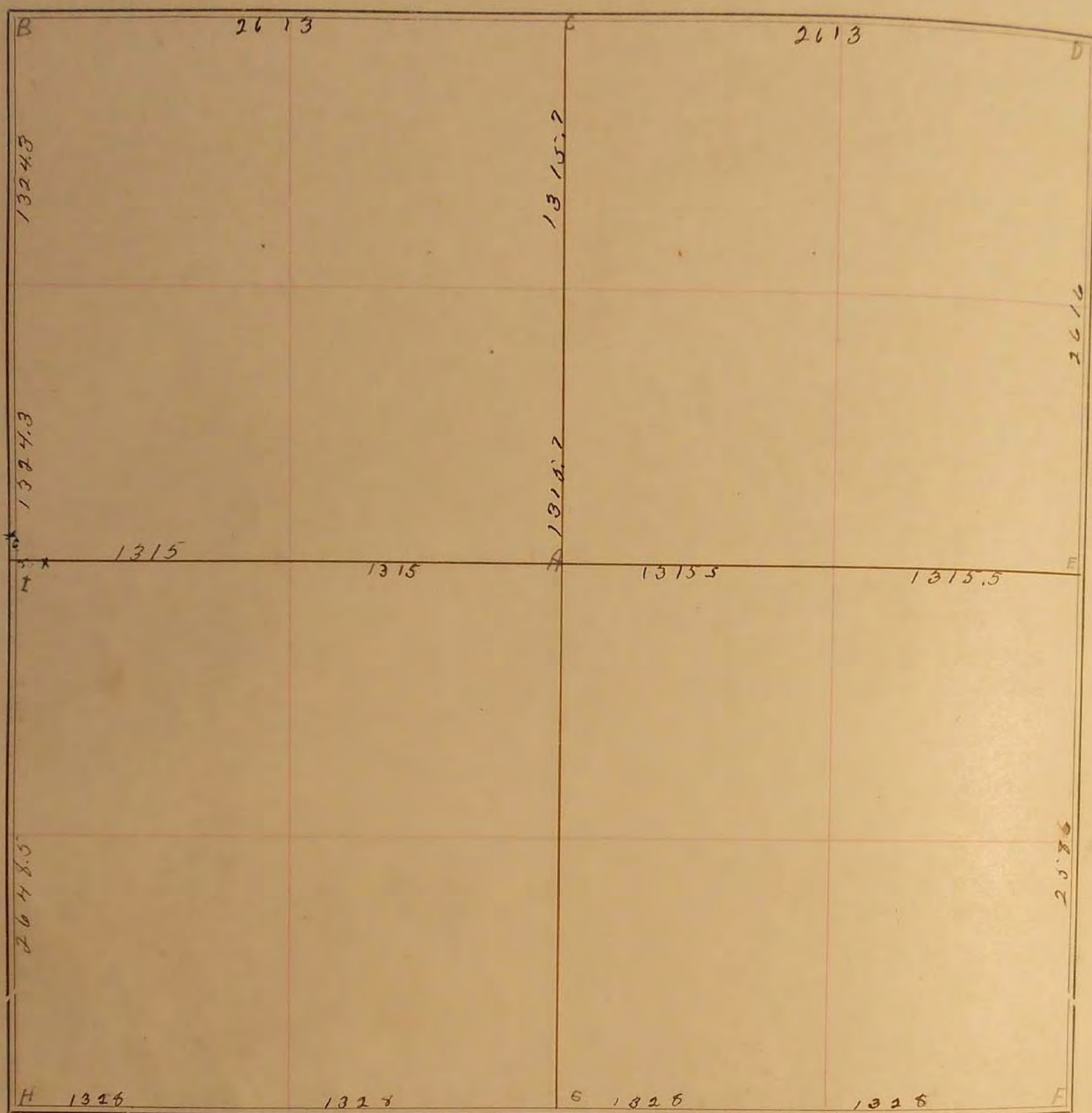

FIELD NOTES.

June, 25, 1907.

J. W. Woolstenhulme

- A
- B
- C
- D
- E
- F
- G
- H
- I

5/8 iron stake ↕ 40' W. & 2' North of 6" Round iron post E. Fence Line

June, -15, 1951.
M.E. Koopman